



Date: 10/02/2018

Health Foundation Nepal (HFN)

Psychiatric Care and Rehabilitation Center, Kuirepani,  
Dang, Nepal

A Progress Report

Submitted to America Nepal Medical Foundation  
(ANMF)

Submitted by: Shreedhar Paudel, MD, MPH  
On behalf of Health Foundation Nepal

## **Introduction**

I appreciate the financial, moral and emotional support of ANMF which tremendously helped HFN proceed on the planned mental health project in rural Nepal. Psychiatric care and rehabilitation center is a community mental health initiatives of HFN in collaboration with a local organization called Movement for Inspiration Nepal (MOFIN). The first phase of the project is the construction of the building for the proposed service. While the construction process is ongoing, HFN is also working on the training and relevant administrative steps so that the mental health services can be started once the building is ready. This report intends to summarize the progress of the project so far.

## **Collaborators and contributions**

### **A. ANMF:**

- Financial contribution approved: \$30,000.00
- Fund already released: \$19,000.00
- The remaining funding to be released in the second phase after evaluating the progress of the project activities: \$11,000.00

### **B. HFN**

- Concept, strategies and planning of the project
- Monitoring and supervising the process of construction of the service center
- Financial contribution: \$21,000.00 as of 10/06/18
- Coordination with collaborators, and concerned stake holders in Dang, Nepal
- Supervising MOFIN on administrative processes

### **C. MOFIN:**

- Purchase of the land
- Administrative steps
- Coordination with the local government and local people
- Garnering support from local people and agencies for free construction materials
- Close collaboration with HFN staffs in implementing the project
- Financial contribution: Through government agencies, fund raising campaign

**Project Activities: As of 10/02/18**

1. Approval of the psychiatric care and rehabilitation center construction map by the local government
2. Finding the local contractor for the construction
3. Initiation of the construction process
4. Regular supervision and monitoring of the construction site by HFN leaders and staffs

Starting from March 2018, the construction process has been progressing as expected. The base, walls and roofs of the 3 blocks of the building have been built. The building needs finishing, furniture, office set up, and clinical set up before it can be used for the service. Please find the pictures and description of the development so far:

A. Pictures showing the construction site, the map and the people at work at the beginning of the construction



Progress report of HFN project on construction of psychiatric care and rehabilitation center

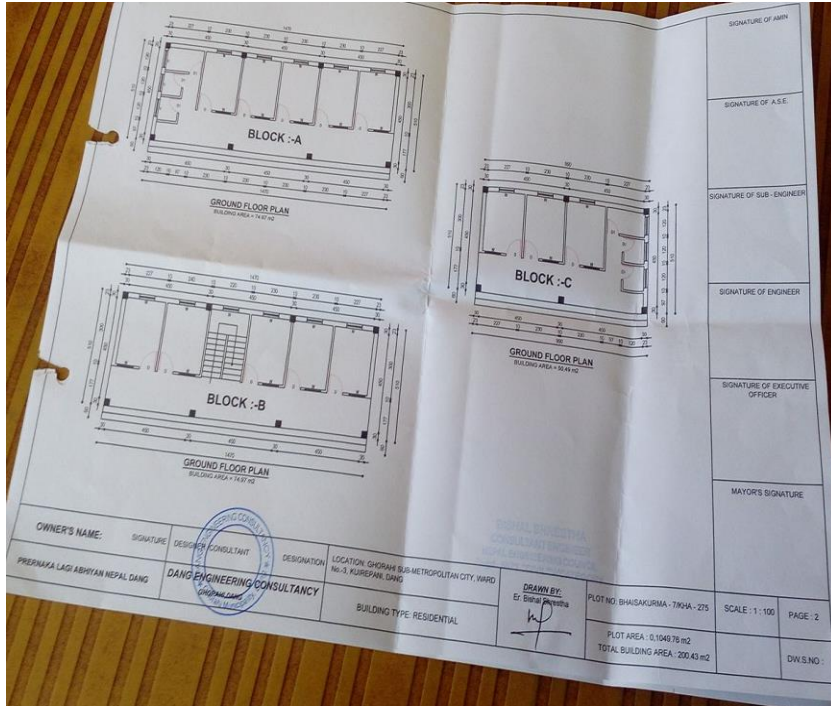

Progress report of HFN project on construction of psychiatric care and rehabilitation center

B. Pictures showing the base and foundation of the building



C. Pictures of the walls and the roofs



Progress report of HFN project on construction of psychiatric care and rehabilitation center



HFN will update the progress of the project as it unfolds. HFN wanted to laud the members and supporters of ANMF who have been playing instrumental role in this project. I hope to get ongoing support from ANMF team to establish this mental health center, and potentially to establish such centers in different parts of the country. Please contact us with any questions or concerns about the project and the expenses of the funding provided by ANMF.

Sincerely yours,

Shreedhar Paudel, MD, MPH

Health Foundation Nepal

healthfoundationnepal@gmail.com

paudel4sd@gmail.com